

TI2007-019

Mini DC to 10AWG Quick Disconnect Cable Assembly



The Tesla™ TI2007-019 Mini DC to 10AWG Quick Disconnect Cable Assembly connects to the TI150 IEC (International Electrotechnical Commission) cord 12/24V Battery Charger/Conditioner. Constructed from a rugged combination of advanced composite materials and corrosion-resistant alloys, the dc connector will withstand the harshest battlefield conditions and other extreme environments. Along with highly conductive contact materials, the virtually indestructible design and fast “in-the-field” component replacement make it the last dc connector you will ever need.

Power Anytime, Anywhere

Features:

- Rated to 25 amps max
- DC Output Cable Quick Disconnect cable ends
- UV, fuel, fungus, water, and oil resistant
- Easy component replacement
- Manufactured by Tesla™
- Exceeds MIL-STD-810F
- Tested to withstand 50 G of force



Tesla™ Industries, Inc.

www.teslaind.com

Email: tesla1@teslaind.com

Headquarters: (302) 324-8910

101 Centerpoint Blvd. New Castle, DE 19720 USA

Western Regional Office: (775) 622-8801

9475 Double R Blvd. Suite 2, Reno, NV 89521 USA



**The POWER
Of
RED™**



Features and Benefits

Rugged, Durable, Reliable

Made from virtually indestructible composite materials, the plug housing won't crack, melt, blister, dry-rot or disintegrate. Through a series of strategically placed seals and bushings, the Tesla™ DC Battery Connector is hermetically sealed to lock out rain, snow, sand and other harmful debris. This, in conjunction with corrosion resistant conductors, insures that the Tesla™ TI2007-019 Mini DC to 10AWG Quick Disconnect Cable Assembly will still be in the field long after other plugs have failed.

Internal Cable Connections

Unlike connectors with cables that are molded directly to the housing, easily crimpable bullets allow for direct termination inside of the connector. This eliminates the need for cumbersome splices.

Replaceable DC Connector Contacts

Manufactured from highly conductive alloys, the contacts feature threads that are resistant to damage and ideal for superior torquing and surface contact. Once installed, contacts are hermetically sealed within the connector. Additionally contacts can be easily replaced "in-the-field" without discarding the entire plug using the Insertion/Extraction Tool. The tool and contact replacements can be ordered through Tesla™ Customer Service at 302-324-8910.

Quick Disconnect Connector

The TI2007-019 Mini DC to 10 AWG Quick Disconnect Cable Assembly is equipped with a male Quick Disconnect connector. This will connect with the female end of the connector which is attached to the TI150 IEC cord 12/24V Battery Charger/Conditioner.



Cable Crimp Bullets: TI2005-199

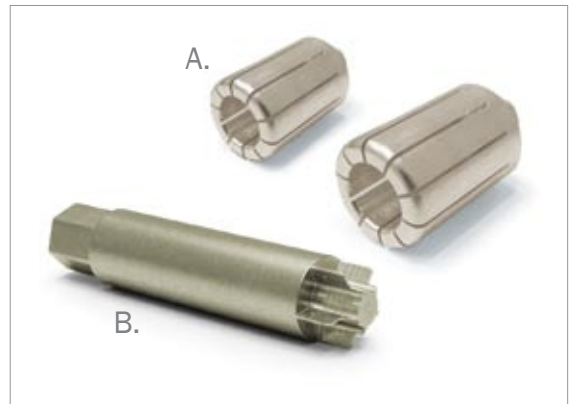

A. Replacement Contacts: TI2005-490
B. Insertion/Extraction Tool: TI2005-488



TI150 Battery Charger/Conditioner



Male Quick Disconnect Connector

Components

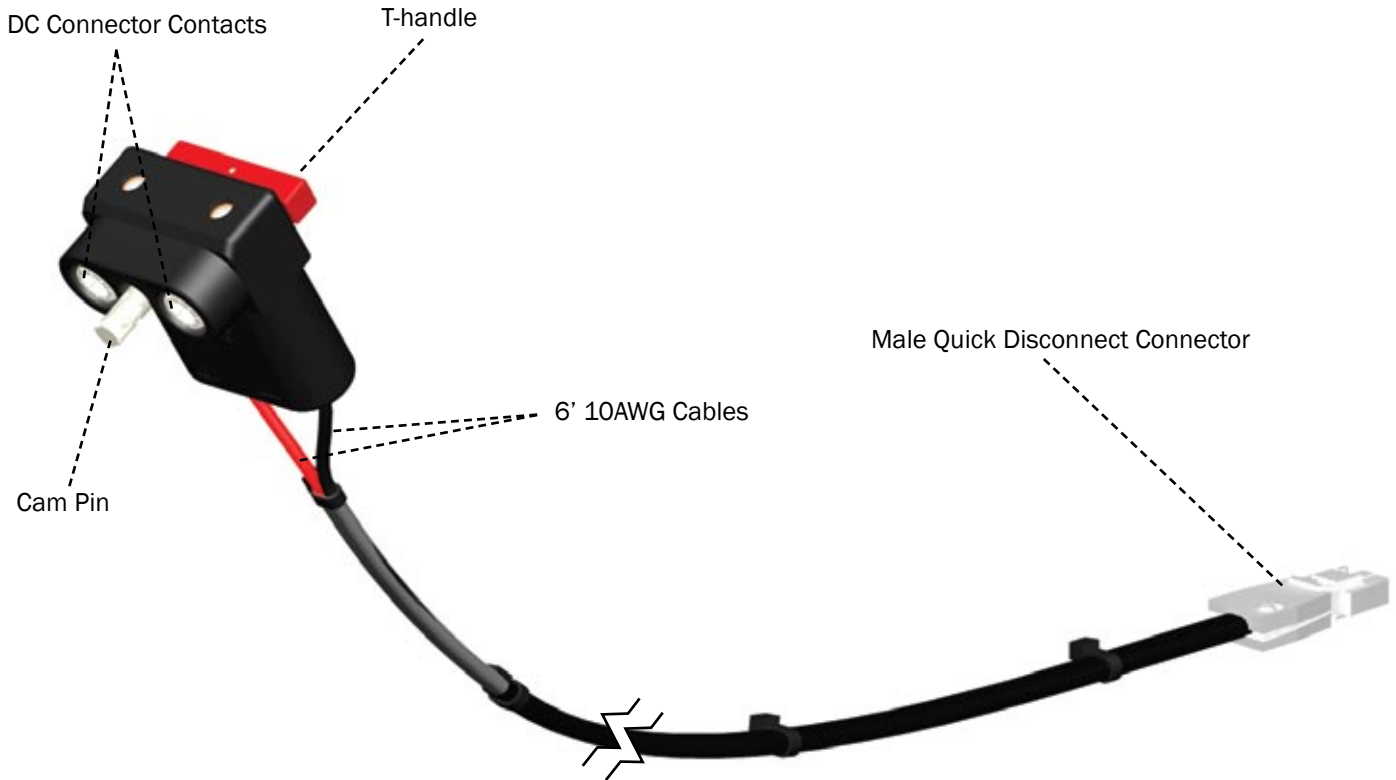

Contact Replacement

Step 1: To remove either contact, insert the hex end of the DC Contact Insertion/Extraction Tool into a 1/2 inch socket wrench.

Step 2: Next, insert the tool into the contact and turn counterclockwise using the wrench.

Steps 3 & 4: To install a new contact, use the same tool and screw the contact in clockwise.

Dimensions and Technical Specifications

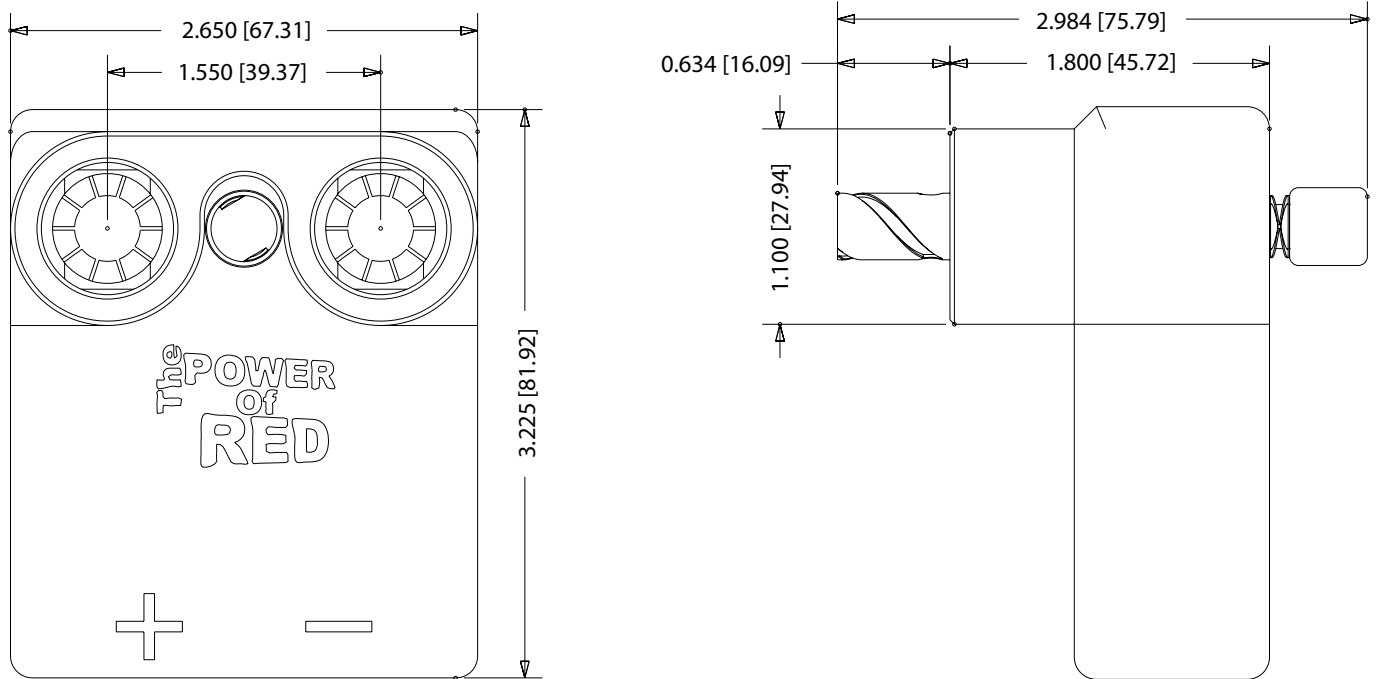

* All dimensions are in inches [millimeters]

Technical Specifications:

Number of Contacts	2
Storage Temperature	-65 °C - 125 °C (-85 °F - 257 °F)
Operating Temperature	-40 °C - 110 °C (-40 °F - 230 °F)
Air Gap-leakage Path	0.55" (14 mm)
Protection Class	IP28C (tested to 20 m)
Rated Current	25 A continuous
Rated Voltage	18 - 32 Vdc
Dielectric Strength	> 6000 Vdc for 1 min across contacts
Insulation Resistance	4 GΩ w/1kV across contacts
Contact Resistance	< 60 μΩ @ 25 °C
Shock	50 G
Vibration	Exceeds MIL-STD-810F
Engagement Torque	6 lbs (2.7 kg)
Warranty	2 years (3 years optional)



* These specifications are for this assembly only. Please refer to Connector Catalog for full specifications of the DC Battery Connector.